

- KEY:
- Carriageway Improvement
  - Footway
  - Property access
  - Verge / Embankment / Landscaping

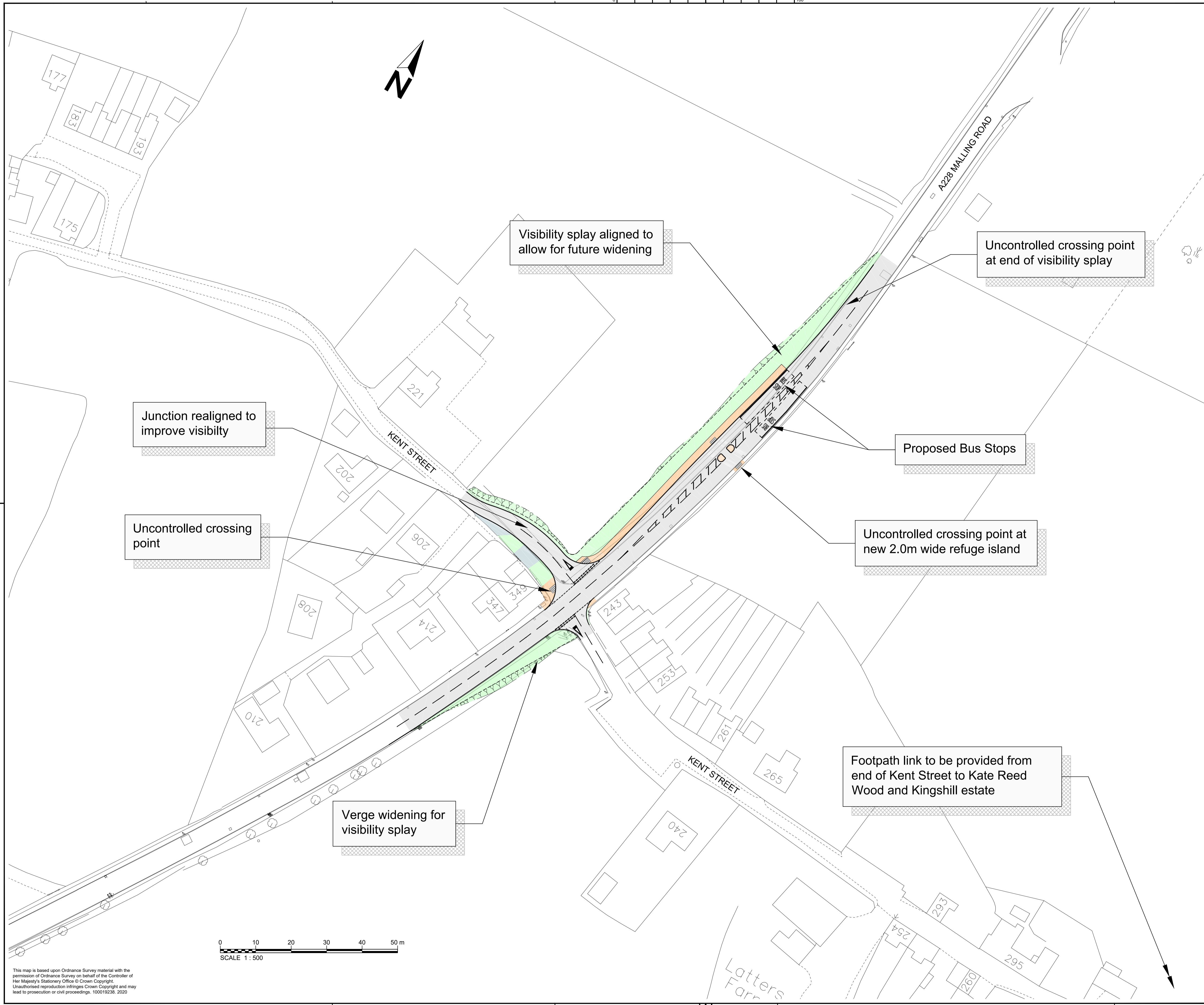

Uncontrolled crossing point at end of visibility splay

Visibility splay aligned to allow for future widening

Proposed Bus Stops

Junction realigned to improve visibility

Uncontrolled crossing point at new 2.0m wide refuge island

Uncontrolled crossing point

Footpath link to be provided from end of Kent Street to Kate Reed Wood and Kingshill estate

Verge widening for visibility splay

Rev	Revision details	Chkd	Appd	Date
Drawn: JR				Preliminary
Design: -				For comment
Chkd: SG				For tender
Appd: RJHF				For construction
Date: 02.10.2020				As constructed



Client  
 Project Name  
**A228 MALLING ROAD, MEREWORTH**  
 Drawing Title  
**PROPOSED LAYOUT - OPTION 3  
 NEW REFUGE ISLAND**

Original Drawing Size : A1      Dimensions : Metres  
 Scale : 1:500      Copyright © Amey

Drawing No  
**4300758/000/10**      Rev  
**0**

This map is based upon Ordnance Survey material with the permission of Ordnance Survey on behalf of the Controller of Her Majesty's Stationery Office © Crown Copyright. Unauthorised reproduction infringes Crown Copyright and may lead to prosecution or civil proceedings. 100019238, 2020

SCALE 1 : 500